

SMOKE SIGNAL

Art No.
9181700



Safety of Life at Sea (SOLAS)



Marine Equipment Directive (MED)

CE 0589



datasheet

The Comet Smoke Signal is a compact Lifebuoy marker which produces dense orange smoke for 15 minutes.

Ships are required to carry 2 markers, one mounted on each bridge wing with the brackets supplied and attached by a line to a 4kg lifebuoy. (An approved Lifebuoy Light should also be attached to the lifebuoy).

The signal is used to mark the position of a man overboard in the water during daylight. It can be automatically deployed by releasing the lifebuoy, or manually activated.

✓ APPLICATION

- Daylight signal attached to 4kg Lifebuoy and used in an emergency to mark the position of man overboard.
- Provides 15 minutes of dense orange smoke.
- Safe to use on petrol or oil covered water.
- Automatic or manual deployment.
- Universal stainless steel mounting bracket. Usually mounted on a ships bridge wing
- Approved mounting height: 56m - but manufacturer tested to survive 100m drop into water. (SOLAS only requires 30m).
- Ideal for use on ships or rigs with high freeboard.
- For use on vessels that cannot fit our combined man overboard 2 hour Light and 15 minute smoke markers, Art. No. 9181600 (USA and Japanese flag vessels require 15 hour lights).

✓ STORAGE

This compact unit is ideally stored in good magazine conditions in an upright position, mounted to its stainless steel bracket in our original packaging.

Onboard vessel: Two units are normally required to be carried. Mounted inverted and attached to a Lifebuoy. Usually positioned on each bridge wing and need a clear, uninterrupted drop into the water.

✓ OPERATION

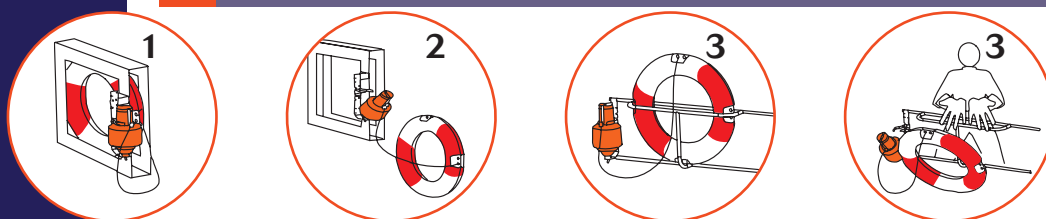

1. Signal and Lifebuoy mounted on bridge wing in ready to fire position.
2. Release locking pin and lifebuoy falls, automatically deploying marker.
3. Alternatively, manually ignite and throw lifebuoy overboard.

WARNING:

- Produces dense orange smoke - do not inhale.
- Do not fire in a confined space
- Keep out of reach of children
- Only for emergency use at sea
- If damaged or dented do not use
- Do not dismantle



- Keep away from source of heat
- Do not use after expiry date

DISPOSAL:

- Pyrotechnics must be treated as hazardous items and must be disposed of responsibly in accordance with local regulations. For help and advice, visit our website www.comet-marine.com

SMOKE SIGNAL

Authorised Dealer

Drew Marine Signal & Safety UK Ltd
Langstone Technology Park
Langstone Road
Havant
Hampshire
PO9 1SA
United Kingdom

Tel: +44 (0)2392 415700
Fax: +44 (0)2392 415701
Email: info@signalandsafety.com



Drew Marine Signal & Safety



Ballast weight

Smoke composition

..... Foamed float

Firing Mechanism

..... Bracket

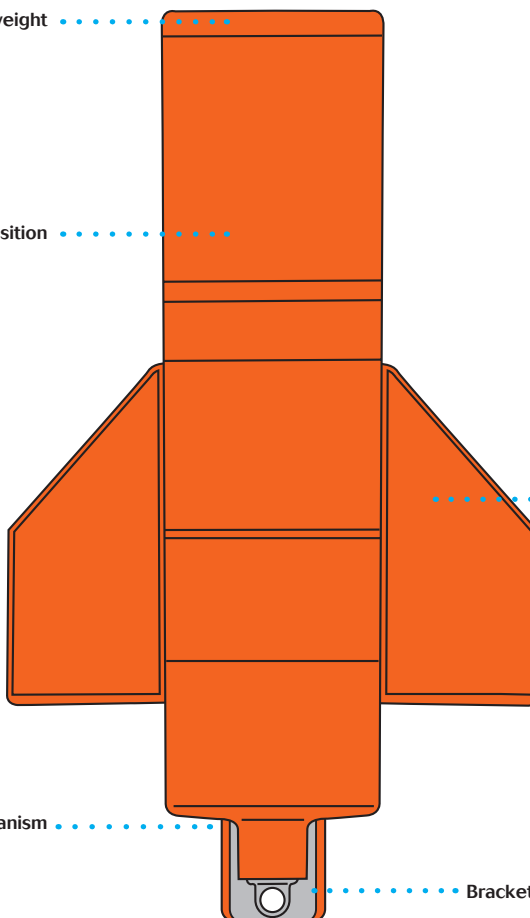

techspec

✓ SPECIFICATION

- Height: 375mm (14.76ins)
- Diameter: 183mm (7.20ins)
- Weight: 3.3kg (7.27lbs)
- Weight – including bracket and angles: 3.85kg (8.5lbs)
- Net Explosive Content: 1.287kg (2.84 lbs)
- Temperature range: -30°C to +65°C
- Burning time: 15 minutes
- Use with lifebuoy weighing: 4.0kg (8.82lbs)
- Attach to lifebuoy with line: 4m (13ft) long, 9.5mm (0.37ins) diameter

✓ APPROVALS

Conforms to SOLAS 1974 as amended. IMO Resolution MSC 81 (70) part 1.
MED: Orange Smoke Signal BGV-422.011. BAM-P1-0596, 0589-P1-0619.
USCG:160.057/29/0, 160.157/29/0.

✓ PACKING & TRANSPORT INFORMATION

- 2 x signals in 1 fibreboard box
- Max. Gross Weight: 8.7 kg (19.2 lbs) per box
- Max. Net Weight: 7.7 kg (17 lbs)
- Measurements of fibreboard box: 360 x 270 x 395 mm (14.2 x 10.6 x 15.6 in)
- Max. Net Explosive Content per box: 2.57kg (5.67 lbs)
- Hazard class 1.4S UN 0507
- Proper shipping name: Signals, Smoke
- Other information: Passenger and cargo aircraft



www.comet-marine.com

Issue:1 06/2015